

SPRING / SUMMER

2013 PRODUCT CATALOG



Sunfire 

IN THE BUSINESS OF



XT Series ■ Imagine a line of Home Theater products that not only exceeds your expectations – but anticipates them, too. Each component designed from the ground up to make everything you've heard before seem virtually obsolete. Welcome to the XT Series from Sunfire.

Sunfire Series ■ The Sunfire line represents nothing less than an audio renaissance. What has long been recognized as a stand out brand – now stands alone – with a range of products that are better in performance, luxury and style than anything that's come before them.

There's a Lot
of You in Every
Sunfire Product

The **2013 Sunfire Product Line** stretches the laws of physics, using cutting-edge technologies in unconventional ways. Today, 29 patents later, Sunfire presents a breadth and depth of products that are each designed for maximum performance. Product categories include subwoofers, speakers, and multi-channel amplifiers. Considered the

DELIVERING POWER

HRS Series ■ The High Resolution Series is a Home Theater lover's reason to celebrate. In addition to possessing many of Sunfire's patented and celebrated technologies, the HRS is easy to install, even easier to enjoy.

DS Series ■ The latest expression of Sunfire's continuing evolution is called the Sunfire Dynamic Series. True to their name, these three all-new subwoofers are both vibrant and forceful, delivering Sunfire's acclaimed blend of powerful bass delivered with both high fidelity and high output.

smallest, most powerful products in their respective classes, Sunfire offers a broader line of relevant home theater products than any other high-end home theater brand in the world. Many discerning consumers demand the highest in performance, quality and overall value. For them, luxury is never optional. For you, there is Sunfire.

QUICK REFERENCE



Atmos Subwoofer

XT-ATM265 Dual 6.5" Subwoofer p3

SubRosa Subwoofers

SRS-210R-SYS In-Room System p4
SRS-210W-SYS In-Wall System p4

Loudspeakers

CRS-3 Cinema Ribbon Trio p5
CRS-3C On-Wall Ribbon Speaker for LCR Applications p6
CRM-2BIPW White Bi-pole Surround p6
CRM-2BIP Black Bi-pole Surround p6
CRW-3C In-Wall Ribbon Speaker for LCR Applications p7
CRW-2C Duo In-Wall Left, Right and Surround p7
Accessories p8

XT SERIES



Amplifiers

TGA-7401, 7x400W TDC Amplifier p9
TGA-7201, 7x200W TDC Amplifier p10

Dual Subwoofers

TS-EQ12 True Sub EQ Signature..... p11
TS-EQ10 True Sub EQ p11
TS-SJ8 True Sub Super Junior..... p11
XT-ATM265 Dual 6.5" Subwoofer..... p2

Solitaire Subwoofers

TS-EQS12 True Sub EQ Solitaire 12 p12
TS-EQS10 True Sub EQ Solitaire 10 p12

SUNFIRE SERIES



Subwoofers

NEW HRSIW8 StillBass™ In-Wall Subwoofer System p14
HRS-12 Subwoofer p16
HRS-10 Subwoofer p16
HRS-8 Subwoofer p16

HIGH RESOLUTION SERIES



Subwoofers

SDS-12 Subwoofer p18
SDS-10 Subwoofer p18
SDS-8 Subwoofer p18
SDSWITX Wireless Transmitter p18
SDSWIRX Wireless Receiver..... p18

DYNAMIC SERIES



When you see this symbol, the product is available in either 230VAC or 240VAC Versions.

Welcome to the TOP of the Food Chain

WELCOME TO SUNFIRE'S XT SERIES

Luxury selling extends well beyond the product. From the performance, to the people, to the services offered — only the industry's premiere dealers possess the cultural DNA needed to cater to elite clientele.

Great design. Remarkable performance. And the satisfaction of knowing your choice was not merely the best one, but the **ONLY** one. It's the feeling Sunfire XT owners experience every day. XT combines the latest technologies and designs with a decades-long list Sunfire's renowned patents, products and proven results.

It is time for you to embrace Sunfire luxury and enjoy the rewards it brings.



XT
Series



baby boomer.

The luxury of 1400 watts of power. The miracle to harness it all in a cabinet just over 8 inches tall. And a sense of purpose that will turn all of your movies and music into a listening experience you've only read about before.

That's the all-new Atmos subwoofer from Sunfire. Atmos is the smallest and most



powerful subwoofer in its class and features everything Sunfire has ever known about designing subwoofers and so much more that we never knew before. Limited in production and simply unrivaled in performance, Atmos is a subwoofer that knows very few limits and respects even fewer.

To find out more, visit us at sunfire.com.



1400 WATTS 24.4 PSI 8 INCHES TALL

XTATM265 INTERNATIONAL

6.5" Dual Driver Powered Subwoofer



Design Features

- Stunning output from a small cabinet
- Active/Passive 6.5" woofer, High Back-emf design
- 1400 Watt TDC™ amplifier
- Asymmetrical Cardioid Surround™ (ACS)
- Output: 106 dB (incl. room gain)
- Frequency response: 30Hz - 100Hz
- Auto room correction w/ included microphone
- Black cabinet

Rear Panel

- Line-level unbalanced inputs
- Line-level outputs with high-pass or full-range switch
- 12 VDC input for remote turn-on
- Continuous variable phase control
- Continuous variable crossover frequency
- Continuous variable volume level control
- Gold-plated inputs and outputs

ORDER NUMBER

XTATM265

SUNFIRE XTAMT256230 (230V)

Dimensions (w/feet)

8.9 x 8.5 x 10.1 (WHD")
(226 x 216 x 275 mm)

Weight

32.0 lb (14.5 kg)

Ship Weight

40 lbs (18.1 kg)

SOLD AS EACH

To order one pair, please indicate a quantity of two (2) on your PO.

The Inner (and Outer) Beauty of Atmos

Auto-room Equalizer Circuit for automatic adjustment to best suit the room's acoustics for maximum bass quality.

Get higher quality and greatly reduced distortion from the **Redesigned Tracking Down-converter Amplifier** and the FEA (Finite Element Analysis)



Asymmetrical Cardioid Surround varies in **thickness** from one side to the other. What does that mean? Well-defined bass that combines extreme output with very low distortion and a unique sound quality.

Aluminum cabinet of various thicknesses is required to handle the gargantuan back-pressures created by this sub's extreme woofer movement.

The feet look and perform like a car tire to keep this powerful sub in the same place in the room at the end of the movie as it was at the start.

The World's Only Flat-Panel Subwoofer with StillBass™ Technology



SRS-210R SubRosa In-Room Subwoofer System

SRS-210R Cabinet

- Sunfire's exclusive, patented StillBass, anti-shake technology which virtually eliminates harmful mechanical vibrations. Reduces the infiltration of bass into other rooms while increasing the acoustical energy for improved dynamic, crisp bass.
- Dual 10" woofers with inverted surround and neodymium magnets for slim profile (3.75" deep)
- Perfect for ON-WALL applications
- High Back-emf design
- Ebonized rosewood with 11-layer lacquer finish

System Performance

- Output: 110 dB SPL (inc. room gain)
- Frequency response: 18Hz - 115Hz
- Auto room correction w/ included microphone

SRA-2700EQ Amplifier

- 2,700 Watt Tracking Downconverter™
- Balanced XLR, RCA and speaker level inputs
- Infinitely variable crossover, phase, and level controls
- Slim 1U design with included rack mount kit
- Removable IEC cord

Accessories

- **SRS-WMK On-Wall Mounting Bracket** for on-wall mounting. StillBass™ technology eliminates mechanical vibrations for ON-WALL mounting. **See page 9 for details.**

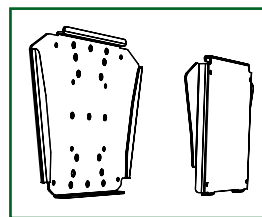

ORDER NUMBER
SRS210R

Cabinet Dimensions
44.5 x 14.25 x 3.75 (WHD")
(1,143 x 362 x 95 mm)

Cabinet Weight
59 lbs (29.5 kg)

Ship Dimensions
48 x 20 x 12 (WHD")
(1,219 x 508 x 304 mm)

System Ship Weight
82 lbs (37.2 kg)

ORDER NUMBER
SRA2700EQ
 SRA2700EQ230

Amplifier Dimensions
17 x 1.75 x 14.25 (WHD")
(432 x 44 x 362 mm)

Ship Dimensions
23 x 5 x 18 (WHD")
(584 x 127 x 457 mm)

Weight
18 lbs (8.2 kg)

Ship Weight
23 lbs (10.4 kg)

SRS210WC
Cabinet Only

SRS210WB
Woofer Baffle
Assembly

SRS210WG
In-Wall Grille



SRA2700EQ Amplifier
see description above

SRS-210W-SYS SubRosa In-Wall Subwoofer System

System Includes:

- SRS210WC cabinet, SRS210WB baffle, SRS210WG grille assembly, and SRA2700EQ amplifier. Parts may be purchased separately according to job phase, see components on left
- Flat black finish cabinet for in-wall use

ORDER NUMBER
SRS210WC
CABINET

ORDER NUMBER
SRS210WG
GRILLE

ORDER NUMBER
SRS210WB
BAFFLE



CINEMA RIBBONS®

The world's most powerful compact speakers



The success of the XT Series Cinema Ribbons has been the story of one of the fastest growing, most successful premium speaker lines ever. Since their introduction in 2006, the Cinema Ribbon line has forever changed the notion that small boxes can't deliver the luxury of premium, audiophile sound. With remarkable output from surprisingly small cabinets, the Cinema Ribbons are emblematic of Sunfire's widely acclaimed design philosophy. Based on a tradition of ribbons dating back to the 1970s with the Carver® Amazing Loudspeaker, all Cinema Ribbons feature a 6-inch ribbon tweeter that is able to deliver the same output as a 5-foot-tall speaker. Borrowing technology from our award-winning subwoofers, accurate low frequency reproduction is handled by miniature High Back-emf woofers that deliver unbelievable bass for cabinets of this size. What's more, On-wall, In-wall, On-stand, and Bi-pole versions are available to suit almost any application. It's OK... Start Believing.



CRS-3 Cinema Ribbon Trio On-Wall Loudspeaker

Design Features

- 6" ribbon with 10' of Kapton® material
- Three 4.5" woofers, High Back-emf design
- Ebonized rosewood lacquer finish
- Power handling: 25-440W
- Frequency response: 80Hz - 40kHz
- Sensitivity: 90dB
- Impedance: 6 ohms (nominal)

Other Features

- Gold-plated binding posts
- Bi-amp capable
- Wall mount hardware included
- Slim form factor pairs perfectly with SubRosa

See page 4 for SubRosa subwoofer systems

ORDER NUMBER CRS3

Dimensions

5.8 x 24 x 3.75 (WHD")
(147 x 609 x 95 mm)

Ship Dimensions

7 x 27 x 9 (WHD")
(178 x 686 x 229 mm)

Weight

15.8 lbs (7.2 kg)

Ship Weight

22 lbs (10 kg)

Color

Ebonized rosewood
lacquer finish

SOLD AS EACH

To order one pair, please
indicate a quantity of two (2)
on your PO.

CINEMA RIBBONS®



CRS-3C

Cinema Ribbon Trio Center Channel

Design Features

- 6" ribbon with 10' of Kapton® material
- Four 4.5" woofers, High Back-emf design
- Ebonized rosewood lacquer finish
- 2.5-way, "tapered array" crossover design
- Power handling: 25-440W
- Frequency response: 80Hz - 40kHz
- Sensitivity: 90dB
- Impedance: 6 ohms (nominal)

Other Features

- Integrated "acoustic lens" in grille for wide horizontal dispersion
- Gold-plated binding posts
- Bi-amp capable
- Wall mount hardware included
- Slim form factor pairs perfectly with SubRosa

See page 4 for SubRosa subwoofer systems

ORDER NUMBER
CRS3C

Dimensions

28 x 5.8 x 3.75 (WHD")
(711 x 147 x 95 mm)

Ship Dimensions

33 x 10 x 7 (WHD")
(838 x 254 x 178 mm)

Weight

19.8 lbs (9.0 kg)

Ship Weight

24 lbs (10.9 kg)

Color

Ebonized rosewood
lacquer finish

SOLD AS EACH



Black Shown

White gloss lacquer
finish also available.

CRM-2BIP

Cinema Ribbon Bi-pole Surround

Design Features

- Dual high output 6" ribbons for a total of 20' of Kapton® material
- 4.5" High Back-emf woofer with "Trifilar" voice coil
- Gloss black lacquer finish
- Power handling: 25-400W
- Frequency response: 80Hz - 40kHz
- Sensitivity: 90dB
- Impedance: 6 ohms (nominal)

Other Features

- Intelligent Tweeter Shaping™ for precise ribbon output adjustment
- Low-profile, 3-5/8" deep cabinet
- Gold-plated binding posts
- Easy key-hole mounting with included template
- **Ideal where listening locations are close to side and rear walls, yet high-power output and a diffused sound is required.**

ORDER NUMBER
CRM2BIPW (WHITE)
CRM2BIP (BLACK)

Dimensions

12.18 x 8.25 x 3.63 (WHD")
(309 x 210 x 108 mm)

Ship Dimensions

16.14 x 16.37 x 12.36 (pair)
(410 x 416 x 314 mm)

Weight

8.0 lb (3.6 kg)

Ship Weight

20 lbs (pair) (508 kg)

SOLD AS EACH



CRM-2

Cinema Ribbon Duo Loudspeaker

Design Features

- 6" ribbon with 10' of Kapton® material
- Two 4.5" woofers, High Back-emf design
- Sonic Hologram Imaging
- Ebonized rosewood lacquer finish
- Power handling: 25-400W
- Frequency response: 95Hz - 40kHz
- Sensitivity: 90dB
- Impedance: 8 ohms (nominal)

Other Features

- Gold-plated binding posts

Accessories

- Optional floor stand (see page 9)
- Optional wall mount hardware (see page 8)

ORDER NUMBER
CRM2

Dimensions

5.5 x 8.25 x 6.0 (WHD")
(140 x 210 x 152 mm)

Ship Dimensions

11 x 9 x 9 (WHD")
(279 x 229 x 229 mm)

Weight

9.0 lbs (4.1 kg)

Ship Weight

10 lbs (4.5 kg)

Color

Ebonized rosewood lacquer finish

SOLD AS EACH



CINEMA RIBBON® IN-WALLS

Remove the acoustic lens and use for
Left AND Right In-Walls, too!



CRW-3C

Cinema Ribbon Trio In-Wall Center Channel

Design Features

- 6" ribbon with 10' of Kapton® material
- Four 4.5" woofers, High Back-emf design
- Textured black finish
- 2.5-way, "tapered array" crossover design
- Power handling: 25-440W
- Frequency response: 80Hz - 40kHz
- Sensitivity: 90dB
- Impedance: 6 ohms (nominal)

Other Features

- Intelligent Tweeter Shaping™ for precise ribbon output adjustment
- Spring loaded, gold-plated binding posts
- Bi-amp capable
- Remove the acoustic lens and use for Left & Right In-Walls, too!

ORDER NUMBER

CRW3C

Dimensions

32.5 x 7.7 x 4.1 (WHD")
(826 x 196 x 103 mm)

Weight

24.4 lbs (11.1 kg)

Cutout Dimensions

230.4 x 6.4 (WH")
(772 x 163 mm)

Ship Weight

32 lbs (14.5 kg)

Color

Textured black finish

Ship Dimensions

12 x 36 x 9 (WHD")
(305 x 914 x 229 mm)

SOLD AS EACH

Remove the acoustic lens and use for
Left AND Right In-Walls, too!



CRW-2C

Cinema Ribbon Duo In-Wall Center Channel

Design Features

- 6" ribbon with 10' of Kapton® material
- Two 4.5" woofers, High Back-emf design
- Textured black finish
- Power handling: 25-400W
- Frequency response: 95Hz - 40kHz
- Sensitivity: 90dB
- Impedance: 6 ohms (nominal)

Other Features

- Intelligent Tweeter Shaping™ for precise ribbon output adjustment
- Spring loaded, gold-plated binding posts
- Remove the acoustic lens and use for Left & Right In-Walls, too!

ORDER NUMBER

CRW2C

Dimensions

23.1 x 7.9 x 4.1 (WHD")
(587 x 200 x 103 mm)

Weight

15 lbs (6.8 kg)

Cutout Dimensions

20.8 x 6.4 (WH")
(528 x 163 mm)

Ship Weight

21 lbs (9.5 kg)

Color

Textured black finish

Ship Dimensions

26.5 x 11 x 8.5 (WHD")
(673 x 279 x 216 mm)

SOLD AS EACH

*See page 4 for SubRosa subwoofer systems *Pre-construction bracket kits (see page 8)

PCK-2/PCK-3C

Duo In-Wall and Trio In-Wall Center
Pre-construction Kits

Description

- PCK-2 Pre-construction bracket for CRW2 and CRW2C loudspeakers
- PCK-3C Pre-construction bracket for CRW3C center channel
- Rugged steel construction

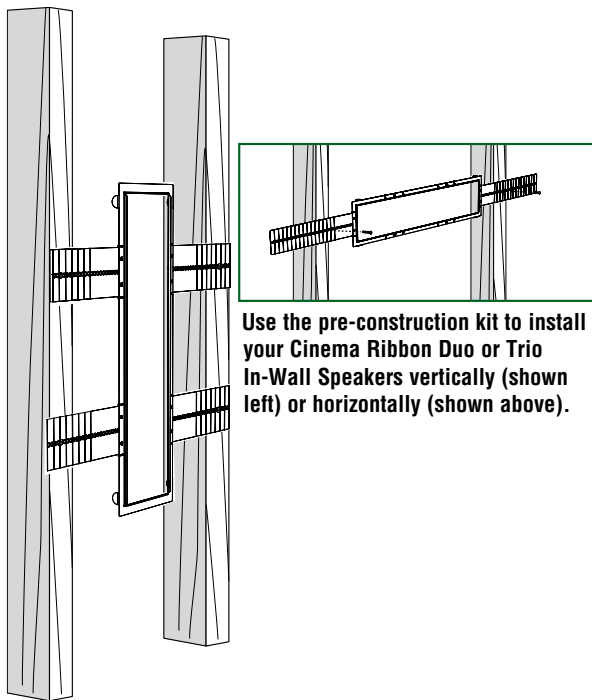

ACC-2WB

Wall Bracket for CRM-2



SRS-WMK

SubRosa On-Wall Mounting Kit

Wall mount the World's Only Flat Panel Subwoofer!
The SubRosa subwoofer includes StillBass™, eliminating unwanted mechanical vibration, making this wall mount and the SubRosa a perfect match to any Flat Panel Display.

Description

- Hangs the SRS210R on the wall horizontally or vertically
- Rugged steel construction

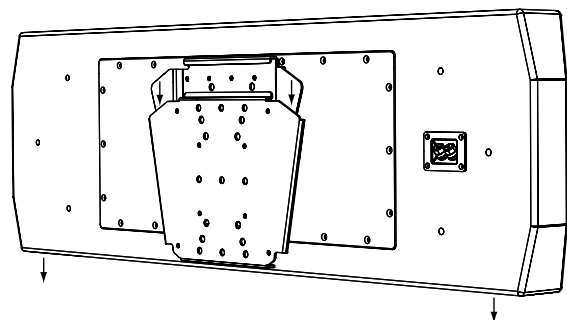
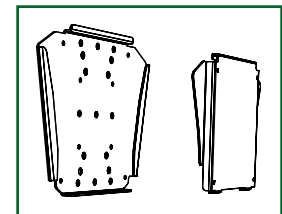



TGA-7401 INTERNATIONAL 7 X 400W Theater Grand Amplifier

Amplification

- 7 channel, Tracking Downconverter™ design
- 400W per channel into 8 ohms with no more than 0.5% THD

Connections

- Sunfire-exclusive current/voltage source outputs for tube amplifier emulation
- Balanced XLR and RCA inputs
- RCA pass-through output for bi-amping
- Signal sense or 12V trigger turn-on

Other Features

- Blue LED with dimmer for power/standby
- Gold-plated inputs and outputs
- CEA color standard, gold-plated binding posts
- Long-grain, solid aluminum front panel
- Removable IEC cord

	ORDER NUMBER TGA7401 TGA7401230
Dimensions 17 x 5.9 x 16.7 (WHD") (432 x 149 x 424 mm)	
Ship Dimensions 22 x 10 x 21 (WHD") (559 x 254 x 533 mm)	
Weight 52 lbs (23.5 kg)	
Ship Weight 54 lbs (24.5 kg)	
Color Duo-Tone only	

Sunfire's patented Tracking Downconverter power supply design dynamically adjusts the output of the TGA-series amplifiers to suit the requirements of the incoming audio signal. On-demand power is available for even the most demanding speakers, while its high efficiency keeps the amplifier cool to the touch.



Unique to Sunfire, the voltage and current source outputs of our TGA-series amplifiers provide the high-current drive benefits of Class A/B (voltage) for punchy bass response, in concert with a warmer tube-like output (current) for high frequencies. The combination is perfectly suited for Sunfire's Cinema Ribbon Trios, which are bi-amp/bi-wire capable (see pgs 5-7).

7 CHANNEL AMPLIFIER



TGA-7201 INTERNATIONAL 7 X 200W Theater Grand Amplifier

Amplification

- 7 channel, Tracking Downconverter™ design
- 200W per channel into 8 ohms with no more than 0.5% THD

Connections

- Sunfire-exclusive current/voltage source outputs for tube amplifier emulation
- Balanced XLR and RCA inputs
- RCA pass-through output for bi-amping
- Signal sense or 12V trigger turn-on

Other Features

- Blue LED with dimmer for power/standby
- Gold-plated inputs and outputs
- CEA color standard, gold-plated binding posts
- Long-grain, solid aluminum front panel
- Removable IEC cord

ORDER NUMBER	TGA7201
	TGA7201230
Dimensions	17 x 5.9 x 16.7 (WHD") (432 x 149 x 424 mm)
Ship Dimensions	22 x 10 x 21 (WHD") (559 x 254 x 533 mm)
Weight	51 lbs (23.1 kg)
Ship Weight	53 lbs (24 kg)
Color	Duo-Tone only



Whatever processor or sophisticated control system you choose, the TGA-series amplifiers can be controlled with ease. Power up automatically when audio is detected, turn on with the TGP, or use a 12V trigger from a control system – the TGAs are ready to turn you on!



TS-EQ12 Signature INTERNATIONAL Dual 12" Powered Subwoofer with Auto EQ



Design Features

- Dual 12" woofers, High Back-emf design
- 2,700 Watt TDC™ amplifier
- Output: 116 dB SPL (inc. room gain)
- Frequency response: 16Hz - 100Hz
- Auto room correction w/ included microphone
- Ebonized rosewood lacquer finish

Rear Panel

- Balanced XLR, RCA and speaker level inputs
- Infinitely variable crossover, phase, and level controls
- Removable IEC cord

ORDER NUMBER TSEQ12 <small>INTERNATIONAL</small> TSEQ12230	
Dimensions 13.5" cubed (343 mm)	Weight 53 lbs (24 kg)
Ship Dimensions 20 x 25 x 20 (WHD") (508 x 635 x 508 mm)	Ship Weight 68 lbs (31 kg)
Color Ebonized rosewood lacquer finish	

TS-EQ10 INTERNATIONAL Dual 10" Powered Subwoofer with Auto EQ



Rear panel configuration for TSEQ12; TSEQ10

Design Features

- Dual 10" woofers, High Back-emf design
- 2,700 Watt TDC™ amplifier
- Output: 110 dB SPL (inc. room gain)
- Frequency response: 18Hz - 100Hz
- Auto room correction w/ included microphone
- Ebonized rosewood lacquer finish

Rear Panel

- Balanced XLR, RCA and speaker level inputs
- Infinitely variable crossover, phase, and level controls
- Removable IEC cord

ORDER NUMBER TSEQ10 <small>INTERNATIONAL</small> TSEQ10230	
Dimensions 11.5" cubed (292 mm)	Weight 48 lbs (21.7 kg)
Ship Dimensions 18 x 23 x 18 (WHD") (457 x 584 x 457 mm)	Ship Weight 60 lbs (27.2 kg)
Color Ebonized rosewood lacquer finish	



Rear panel configuration for TSSJ8

TS-SJ8 Super Junior Dual 8" Powered Subwoofer

Design Features

- Dual 8" woofers, High Back-emf design
- 1,500 Watt TDC™ amplifier
- Output: 108 dB SPL (inc. room gain)
- Frequency response: 25Hz - 100Hz
- Ebonized rosewood lacquer finish

Rear Panel

- RCA and speaker level inputs
- Infinitely variable crossover, phase, and level controls
- Removable IEC cord

ORDER NUMBER TSSJ8	
Dimensions 9" cubed (228 mm)	Weight 29 lbs (13.1 kg)
Ship Dimensions 15 x 19 x 15 (WHD") (381 x 483 x 381 mm)	Ship Weight 38 lbs (17.2 kg)
Color Ebonized rosewood lacquer finish	



TSEQS12 / TSEQS10
Shown with and without grille

TS-EQS12 Solitaire 12

Single 12" Powered Subwoofer with Auto EQ

Design Features

- Single 12" woofer, High Back-emf design
- 1,500 Watt TDC™ amplifier
- Output: 113 dB SPL (inc. room gain)
- Frequency response: 16Hz - 100Hz
- Auto room correction w/ included microphone
- Gloss black lacquer finish

Rear Panel

- Balanced XLR, RCA and speaker level inputs
- Infinitely variable crossover, phase, and level controls
- Removable IEC cord

ORDER NUMBER TSEQS12	
Dimensions 13 x 13.5 x 13.9 (WHD") (330 x 343 x 353 mm)	Weight 50 lbs (22.7 kg)
Ship Dimensions 20 x 25 x 20 (WHD") (508 x 635 x 508 mm)	Ship Weight 64 lbs (29 kg)
Color Gloss black lacquer finish	



Rear panel configuration for TSEQS12; TSEQS10

TS-EQS10 Solitaire 10

Single 10" Powered Subwoofer with Auto EQ

Design Features

- Single 10" woofer, High Back-emf design
- 1,500 Watt TDC™ amplifier
- Output: 107 dB SPL (inc. room gain)
- Frequency response: 18Hz - 100Hz
- Auto room correction w/ included microphone
- Gloss black lacquer finish

Rear Panel

- Balanced XLR, RCA and speaker level inputs
- Infinitely variable crossover, phase, and level controls
- Removable IEC cord

ORDER NUMBER TSEQS10	
Dimensions 11 x 11.5 x 11.9 (WHD") (279 x 292 x 302 mm)	Weight 40 lbs (18.1 kg)
Ship Dimensions 18 x 23 x 18 (WHD") (457 x 584 x 457 mm)	Ship Weight 66.6 lbs (30.2 kg)
Color Gloss black lacquer finish	

Meet the newest HRS Subwoofer,
THE HRSIW8 IN-WALL SUBWOOFER SYSTEM
with Sunfire's patented anti-shake technology, StillBass™



Sunfire | HRS™

IN-WALL SUBWOOFER

HRS™

HRSIW8CAB

In-Wall Subwoofer (MUST BE USED WITH HRSIW8AMP)



ORDER NUMBER HRSIW8CAB

- Cabinet Dimensions**
24 5/8" x 12 1/8" x 3.75" (WHD")
(625 x 306 x 95 mm)
- Cutout Dimensions**
10 5/8" x 23 9/16"
(270 x 599 mm)
- Mounting Depth**
3 3/4" (95 mm)
- Ship Dimensions**
30 1/8" x 11.25" x 17 7/8"
(765 x 285.5 x 453 mm)
- Cabinet Weight**
27.5 lbs (12.46 kg)
- Shipping Weight**
36.8 lbs (16.7kg)

Design Features

- Sunfire's exclusive, patented StillBass™, anti-shake technology which virtually eliminates harmful mechanical vibrations. Reduces the infiltration of bass into other rooms while increasing the acoustical energy for improved dynamic, crisp bass.
- Fits into a standard 16" on-center 2x4 stud construction
- Sunfire's award-winning High Back-emf sealed enclosure for maximum control of the woofers
- Wire channel on rear to avoid pinching the speaker wire between the drywall and the sub enclosure
- Dual 8" woofers
- Designed for retrofit mounting
- Paintable, removable grill attaches flush with magnets
- Wall cut-out template supplied
- Equalized to work only with the Sunfire HRSIW8AMP amplifier (see below)

System Performance

- Multiple DSP/EQ adjustments for maximum output level and fidelity no matter where the woofer is located
- Lock-out feature preserves your custom settings
- Frequency Response: 33 Hz - 150 Hz (-3dB)
- Maximum Output: Greater than 106 dB peak SPL (includes room gain) and measured at 1 meter, anechoic

HRSIW8AMP

Amplifier for HRSIW8CAB (MUST BE USED WITH HRSIW8CAB)



Includes credit card type remote – one-button push for pre-programmed EQ modes, night mode, volume and more.

ORDER NUMBER HRSIW8AMP HRSIW8AMP230

- Amplifier Dimensions**
17 x 1 3/4 x 11 1/4" (WHD")
(432 x 44 x 284 mm)
- Ship Dimensions**
23" x 5.125" x 16"
(582 x 130 x 405 mm)
- Weight**
17.6 lbs (8 kg)
- Ship Weight**
21.2 lbs (9.6 kg)

Design Features

- Includes the Science of Sunfire's Frequency Filtration Design (FFD) for detailed fidelity playback for all source content
- Crossover Frequency: The DSP of the amplifier allows the high-cut filter to be adjusted from the 40 Hz - 160 HZ, with an LFE bypass position and 12 - 36 dB/octave adjustable slope.
- Maximum Power: 520W RMS
- Balanced XLR or RCA inputs
- 120 VAC and 230 VAC compatible
- 12v trigger input
- Rear panel IR input
- Drives 1 or 2* HRSIW8 subwoofer cabinets
- Five listening modes set by the included credit card type IR remote
- Slim 1U design with included rack mounts



WHITE KNUCKLE PERFORMANCE.

(IN AN ITTY BITTY BOX)



Conventional wisdom has always held that big sound can only come from equally statuesque speaker. That is, until Sunfire introduced its radical new High Resolution Series subwoofers. Witness the HRS-8 Subwoofer, that delivers a heart-stopping 1,000 Watts of audiophile-quality performance and it does it from the smallest form factor to ever do so. And when your space needs even more bass, consider it's larger siblings, the HRS-10 and 12-inch models.

Is all this magic? Well, not entirely. It's Sunfire's legendary High Back-emf woofers that make enormous sound happen in very small cabinets. No other company has more experience doing it. And speaking of cabinets - these are finished in a gorgeous, gloss black piano lacquer.

So, while the HRS Subwoofer is not the first good thing to come in a small package, it's certainly the least conventional.

Sunfire | HRS™

HRS-12 INTERNATIONAL

Single 12" Powered Subwoofer



Design Features

- Single 12" woofer, High Back-emf design
- 1,000 Watt TDC™ amplifier
- Output: 108 dB SPL (inc. room gain)
- Frequency response: 18Hz - 100Hz
- Gloss black lacquer finish

Rear Panel Features

- RCA and speaker level inputs
- Infinitely variable crossover, phase, and level controls
- Removable IEC cord

ORDER NUMBER HRS12 HRS12230 (230V)	
Dimensions 13.5" cubed (343 mm)	Weight 38 lbs (17.2 kg)
Ship Dimensions 20 x 20 x 20 (WHD") (508 x 508 x 508 mm)	Ship Weight 51 lbs (23.1 kg)
Colors Gloss black lacquer finish	

HRS-10 INTERNATIONAL

Single 10" Powered Subwoofer



Rear panel configuration for HRS12; HRS10; HRS8; HRS8CH

Design Features

- Single 10" woofer, High Back-emf design
- 1,000 Watt TDC™ amplifier
- Output: 105 dB SPL (inc. room gain)
- Frequency response: 20Hz - 100Hz
- Gloss black lacquer finish

Rear Panel Features

- RCA and speaker level inputs
- Infinitely variable crossover, phase, and level controls
- Removable IEC cord

ORDER NUMBER HRS10 HRS10230 (230V)	
Dimensions 11.5" cubed (292 mm)	Weight 34 lbs (15.4 kg)
Ship Dimensions 18 x 18 x 18 (WHD") (457 x 457 x 457 mm)	Ship Weight 43 lbs (19.5 kg)
Colors Gloss black lacquer finish	

HRS-8 INTERNATIONAL

Single 8" Powered Subwoofer

Design Features

- Single 8" woofer, High Back-emf design
- 1,000 Watt TDC™ amplifier
- Output: 102 dB SPL (inc. room gain)
- Frequency response: 22Hz - 100Hz
- Gloss black lacquer finish
- Gloss white lacquer finish (230V model only)

Rear Panel Features

- RCA and speaker level inputs
- Infinitely variable crossover, phase, and level controls
- Removable IEC cord

ORDER NUMBER HRS8 (Black) HRS8230 (White 230V)	
Dimensions 10" cubed (254 mm)	Weight 28 lbs (12.7 kg)
Ship Dimensions 15 x 15 x 15 (WHD") (381 x 381 x 381 mm)	Ship Weight 37 lbs (16.8 kg)
Colors Gloss black lacquer Gloss white lacquer (230V model only)	

THE STANDARD BY WHICH ALL ITS CLASSMATES WILL BE JUDGED. AGAIN.



SUNFIRE.COM



“I have spent my entire career in designing unique audio products that deliver beyond expectations, and I believe we have done it again with the Dynamic Series”...

~Bob Carver

Now you can satisfy your audio obsession with a premium Sunfire Subwoofer at a price that was never before possible. Our all-new SDS Series delivers up to 600 Watts of dependable, cool-running Sunfire bass wrapped in the smallest cabinet of any product in its class. And because power means nothing without great fidelity, all SDS Series subwoofers incorporate something no other subwoofer can: Sunfire's proprietary FFD technology. FFD lets you indulge in low distortion, high-output performance from both movies and music – not movies or music like those other brands. It's this kind of obsession with power and value that's made Sunfire subwoofers the ones to beat for 15 years.



DS SUBWOOFERS



SDS-12 INTERNATIONAL

12" Dual Driver Powered Subwoofer



Design Features

- Active/Passive 12" woofer, High Back-emf design
- 300W RMS Power Rating
- Class D Amp with FFD™ technology
- Front firing active woofer, down firing passive radiator
- Output: 106 dB
- Frequency response: 28Hz - 150Hz
- Black ash cabinet
- Optional 2.4GHz Wireless Transmitter and Receiver for no-new-wires installation

ORDER NUMBER SDS12 SDS12230 (230V)	
Dimensions* 14.75 x 16.56 x 16.06 (WHD") (375 x 421 x 408 mm)	Weight 35 lbs (15.9 kg)
Ship Dimensions 19.96 x 20.87 x 21.46" (507 x 530 x 545 mm)	Ship Weight 43 lbs (19.5 kg)
Color Black ash	

*includes grille and feet

SDS-10 INTERNATIONAL

10" Dual Driver Powered Subwoofer



Rear panel configuration for the SDS12, SDS10 and SDS8

Design Features

- Active/Passive 10" woofer, High Back-emf design
- 250W RMS Power Rating
- Class D Amp with FFD™ technology
- Front firing active woofer, down firing passive radiator
- Output: 103 dB
- Frequency response: 30Hz - 150Hz
- Black ash cabinet
- Optional 2.4GHz Wireless Transmitter and Receiver for no-new-wires installation

ORDER NUMBER SDS10 (Black) SDS10230 (Black 230V)	
Dimensions* 13.25 x 15.06 x 13.25 (WHD") (337 x 383 x 337 mm)	Weight 27 lbs (12.2 kg)
Ship Dimensions 18.42 x 19.29 x 19.92" (468 x 490 x 506 mm)	Ship Weight 37 lbs (16.8 kg)
Color Black ash	

*includes grille and feet

SDS-8 INTERNATIONAL

8" Dual Driver Powered Subwoofer



SDSWITX Wireless Transmitter SDSWIRX Wireless Receiver

Design Features

- Purpose-built for subwoofer applications
- Digital transmission
- Subs per transmitter 2 max
- Wireless range 7.25m (25 feet) max (one transmitter/one receiver)

Design Features

- Active/Passive 8" woofer, High Back-emf design
- 200W RMS Power Rating
- Class D Amp with FFD™ technology
- Front firing active woofer, down firing passive radiator
- Output: 100 dB
- Frequency response: 32Hz - 150Hz
- Black ash cabinet
- Optional 2.4GHz Wireless Transmitter and Receiver for no-new-wires installation

ORDER NUMBER SDS8 (Black) SDS8230 (Black 230V)	
Dimensions* 11.75 x 13.63 x 11.75 (WHD") (298 x 346 x 298 mm)	Weight 20 lbs (9.1 kg)
Ship Dimensions 16.77 x 17.64 x 18.23" (426 x 448 x 463 mm)	Ship Weight 35 lbs (15.9 kg)
Color Black ash	

*includes grille and feet

TERMS AND CONDITIONS

GENERAL

The products listed in this price sheet are available for sale only to Authorized Sunfire Dealers. As appropriate, please specify color when ordering. If no color is specified, Black will be shipped.

CHANGES AND CORRECTIONS

Prices and specifications are subject to change without notice.

WARRANTY

Sunfire warrants its products to be free from defects in workmanship and materials for the period outlined below. The warranty covers parts and labor. All repairs are to be done by an authorized Sunfire repair facility. The customer is responsible for freight-in to the service facility. Sunfire is responsible for freight-out returning the goods to the customer.

XT-Series

*Five years from date of purchase.
Proof of purchase required.*

HRS Subwoofers

*One year from date of purchase.
Proof of purchase required.*

Amplifiers

*Five years from date of purchase.
Proof of purchase required.*

Sunfire True Sub Series

*Two years from date of purchase.
Proof of purchase required.*

SDS Subwoofers

*Three years from date of purchase.
Proof of purchase required.*

Accessories

*One year from date of purchase.
Proof of purchase required.*

You must contact Sunfire to obtain a Return Authorization Number before returning products for service. Units without RA's will not be accepted.

Sunfire Support, Petaluma CA: (760)710-0990 or www.sunfire.com

©2013 Core Brands, LLC. All rights reserved. Sunfire® is a registered trademark of Core Brands, LLC, a subsidiary of Nortek, Inc.

SUNFIRE DOCUMENTATION

Owner's manuals, white papers, and some application guides are available at sunfire.com/downloads.asp

APPLICATION GUIDES

Cinema Ribbon

SubRosa

Atmos

HRSIW8

ALL OWNER'S MANUALS

WHITE PAPERS

Amplifier Whitepaper

True Subwoofer Whitepaper

Cinema Ribbon Whitepaper

Sonic Holography Whitepaper

All material in this Sunfire catalog is the protected Intellectual Property of Sunfire. Any use of any pictures, logos, copy or other material included herein is prohibited under the intellectual property rights laws. Any use of this material must be approved in writing by Sunfire prior to publication by anyone in any media, not limited to brochures, sales materials, consumer communication in writing, on the internet or by any other written means.

The Sunfire logo features the brand name in a stylized, cursive font with a small starburst graphic at the end of the word.

All information in this catalog is deemed reliable but subject to change without notice.

Sunfire 

Petaluma, CA 94954 USA

760.710.0990

sunfire.com